

TOWEL RAIL

Installation Instructions

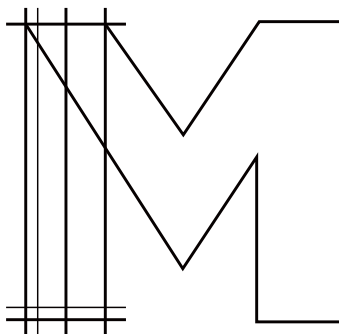

Merranox Technology (Shanghai) Co., Ltd

Address

Room 118, Building 20, No 1-42,
Lane 83, Hong Xiang Bei Road,
Lin Gang Xin District,
Shanghai, China.

Email info@merranox.com

Website www.merranox.com

IMPORTANT: We recommend consulting a professional if you are unfamiliar with this type of installation.

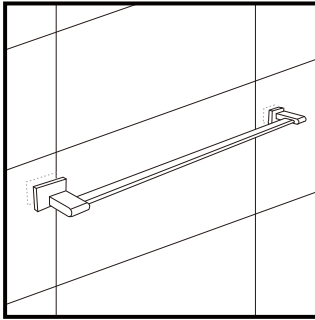

Step 1

At desired location, find the best suited height for towel rail. The industry standard is around 48 inches from floor, you may use this as reference but need to take your family members (especially children) into account.

Hold the towel rail against the wall on desired location and check if there is any stud behind by using stud finder.

If studs are available, you can use panhead screws. If stud is not available, wall anchors need to be drilled. Anyway, at least wall anchor is recommended to be used to secure the towel rail even though studs are available.

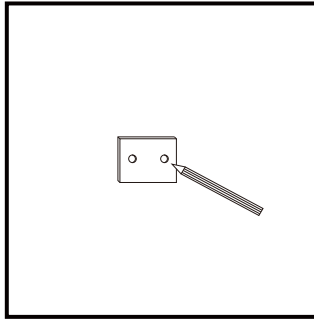

Step 2

Measure the length of towel rail and reconfirm the height is at desired position. Place the mounting brackets at desired location and mark the holes with pencil on the wall.

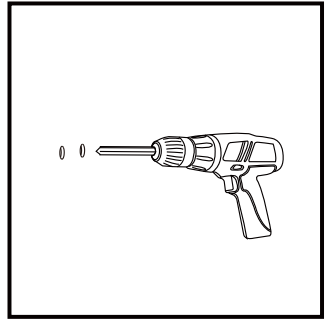

Step 3

Hold the brackets in position against the wall and ensure the marks are even. Drill the holes at marked area.

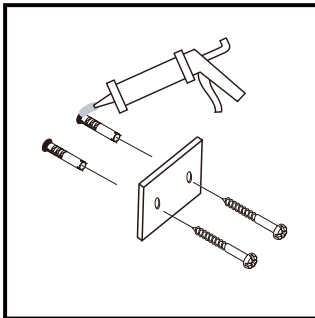

Step 4

If you are using anchors, fit the anchors into holes, then attach the mounting brackets by screws.

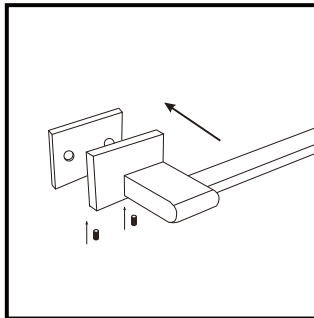

Step 5

Attach one of the bar holders to the bracket by using the screws and wrench provided. Bar was fit in place by sliding into position follow by attach another side of bar holder. Try to put some pressure on the fixed bar to ensure it is securely fasten.

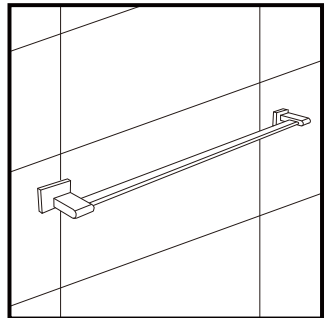

Step 6

Towel rail is now ready to hang towel.

IMPORTANT: We recommend consulting a professional if you are unfamiliar with this type of installation.