

TWO PIECES OPEDESTAL BASIN

Installation Instructions

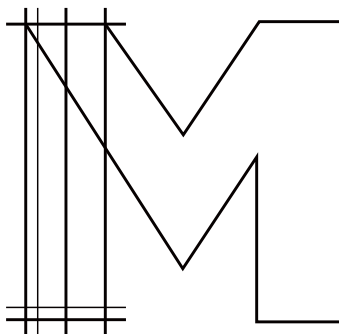

Merranox Technology (Shanghai) Co., Ltd

Address

Room 118, Building 20, No 1-42,
Lane 83, Hong Xiang Bei Road,
Lin Gang Xin District,
Shanghai, China.

Email info@merranox.com

Website www.merranox.com

IMPORTANT: We recommend consulting a professional if you are unfamiliar with this type of installation.

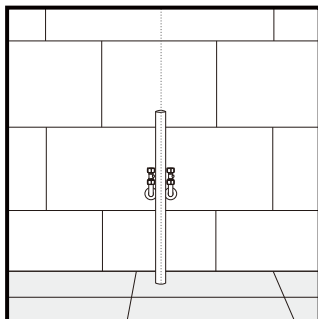

Step 1

Find a centerline at desire location where to fix the pedestal basin. Extend the line along the floor.

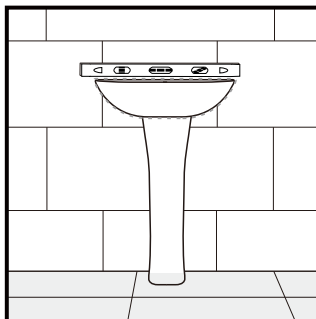

Step 2

Attach the basin to the pedestal and place into position. Level and square the basin and pedestal assembly by using a spirit level. Mark the wall through the mounting holes.

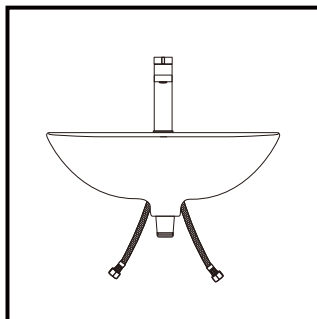

Step 3

Install faucet and pop up waste as per instructions before assembly the basin.

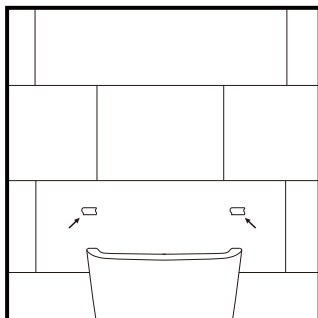

Step 4

Before drilling the bolt holes, use a masking tape to prevent drill slipping on the tiles.

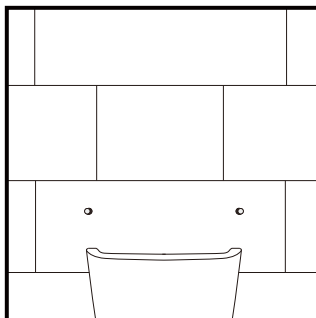

Step 5

By using the corresponding bit size, drill the pilot holes and insert the fixing bolts.

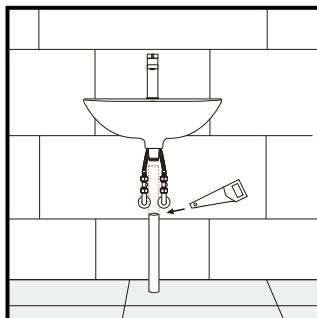

Step 6

Secure the basin to the wall and be sure not to over-tighten the bolts to prevent cracks and damage to basin. Measure the waste pipe to the desired length and cut it accordingly.

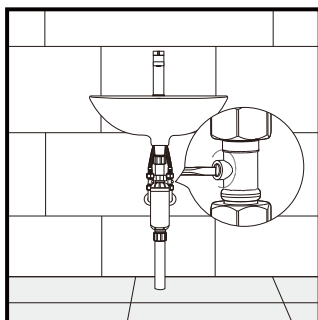

Step 7

Complete the water supply connections to the faucet and fit the waste trap according to manufacturer's instructions. Run water into washbasin and inspect all the connections for leaks before fixing the pedestal.

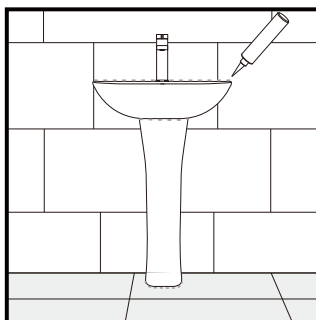

Step 8

By using silicone sealant, seal and join the pedestal. Low tack tape can be used for a neat finish.

IMPORTANT: We recommend consulting a professional if you are unfamiliar with this type of installation.