

WALL HUNG BASIN

Installation Instructions

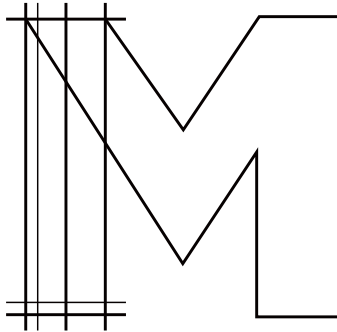

Merranox Technology (Shanghai) Co., Ltd

Address

Room 118, Building 20, No 1-42,
Lane 83, Hong Xiang Bei Road,
Lin Gang Xin District,
Shanghai, China.

Email info@merranox.com

Website www.merranox.com

IMPORTANT: We recommend consulting a professional if you are unfamiliar with this type of installation.

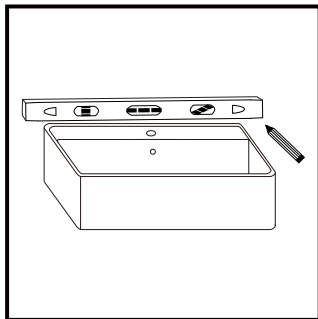

Step 1

Hold the ceramic basin at the desired installation location, ensure that the basin is level by using spirit level. Use a pencil to mark the mounting holes at the back of basin, using the holes in.

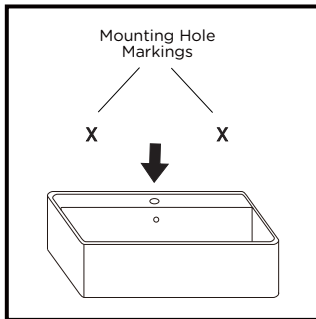

Step 2

Move the washbasin away from installation location. Install the drain and faucet onto basin before moving to next step for conveniences.

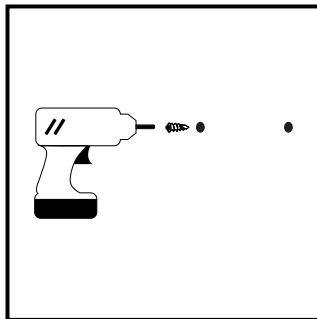

Step 3

By using the corresponding bit size, drill pilot holes at the marked mounting holes. If using anchors, insert the anchors into the drilled holes.

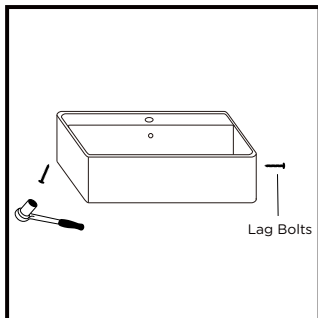

Step 4

Move the washbasin back to the desired fixing location. By using lag bolts, secure the basin to the wall by tightening the bolts using a socket wrench.

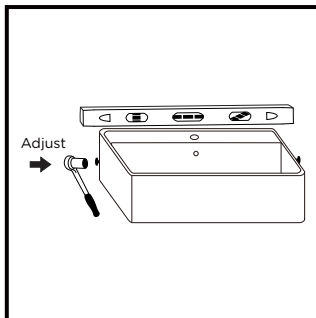

Step 5

Ensure the washbasin remained level and aligned during securing. Slightly loosen the lag bolts for adjustment if needed.

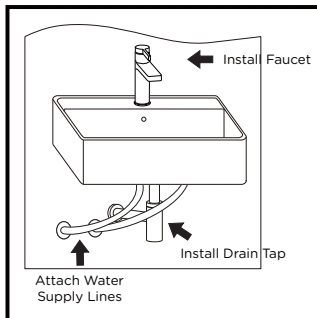

Step 6

Install the faucet, drain tap and water supply lines if not already installed in earlier step. Please refer to the respective installation guides if necessary.

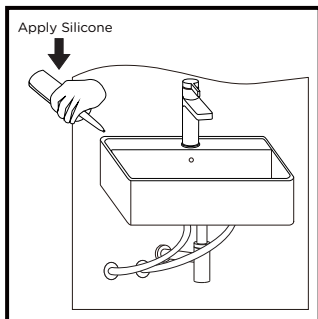

Step 7

To prevent water flowing to the back of basin and damaging the drywall, apply silicone adhesive around the back of washbasin, at the edge where it meets the wall.

IMPORTANT: We recommend consulting a professional if you are unfamiliar with this type of installation.